



Item: _____
 Quantity: _____
 Project: _____
 Approval: _____
 Date: _____

Polar Cuisine Remote Refrigerated Or Freezer Base

Models:

REFRIGERATION UNITS

- BRR-1-02-36US BRR-2-04-48US BRR-2-04-54US BRR-2-04-60US
- BRR-2-04-66US BRR-2-04-72US BRR-3-06-72US BRR-3-06-84US BRR-3-06-90US
- BRR-3-06-96US BRR-3-06-102US BRR-4-06-108US BRR-4-08-114US BRR-4-08-120US

FREEZER UNITS

- BFR-1-02-36US BFR-1-02-48US
- BFR-2-04-54US BFR-2-04-60US BFR-2-04-66US BFR-2-04-72US BFR-3-06-72US



Remote Refrigerated Base shown with optional casters

Standard Features:

- Refrigerator/Freezer cabinet interior, front and side stainless steel
- Drawers and cabinet are 100% "shot in place" foam insulation
- Self closing drawers with heavy duty 2" (51mm) skate wheels with a stainless steel tract
- Heavy duty, long life PVC drawer gaskets
- Center located, flush mount handle for positive opening and reduced stress points on drawer
- Easy to remove drawers for cleaning and set-up
- No exposed fasteners
- Designed to accommodate standard hotel pans in configurations to suit your needs

- Front, face mounted dial thermometers
- Blower coil evaporator with R-404A expansion valve standard
- Internal conduit for single point electrical connection
- Sleeves provided for refrigeration and drain lines
- Stainless steel adjustable 6" (152mm) legs

NOTE: Electrical junction box, drain line and refrigeration are all standard left rear connection. Compressor by others. Consult factory for other locations.

Optional Features:

- Padlock assemblies
- 6" (152mm) casters, front locking (5"/127mm diameter wheel)

Specifications:

US Range low height Remote Refrigerated or Freezer Base model _____ to be exclusively used under US Range Heavy Duty Cuisine Series modular tops. Stainless steel refrigerated or freezer base interior, front face, drawers and sides. 3/8" (10mm) radius bottom and vertical corners of inner liner. Bottom and back of base of galvanized steel. 100% polyurethane shot-in-place foam, free of any CFCs insulation for cabinet and drawer faces. Stainless steel self closing drawer track assemblies with heavy duty 2" (51mm) skate wheels with concealed bearings. Heavy duty, long life PVC drawer gaskets. R-404A blower coil evaporator with expansion valve, concealed pre-wired electrical conduit to a single point connection, dial thermometer and sleeve for drain and refrigeration lines. 6" (152 mm) stainless steel legs with 2" (51mm) adjustable bullet feet.



NOTE: Bases supplied with casters must be installed with an approved restraining device.

Garland Commercial Industries, LLC
 185 East South Street
 Freeland, PA 18224
 Phone: (570) 636-1000
 Fax: (570) 636-3903

Garland Commercial Ranges Ltd
 1177 Kamato Road,
 Mississauga, Ontario
 L4W 1X4 CANADA
 Phone: 905-624-0260
 Fax: 905-624-5669

Enodis UK LTD
 Swallowfield Way,
 Hayes, Middlesex
 UB3 1DQ ENGLAND
 Telephone: 081-561-0433
 Fax: 081-848-0041



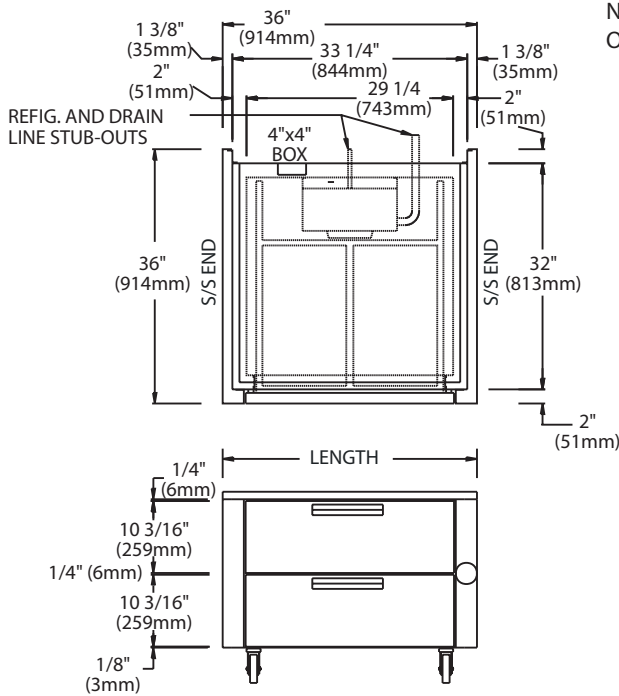

Note: Bases must be ordered with a U.S. Range Cuisine Units Only
Optional pressure Regular required.

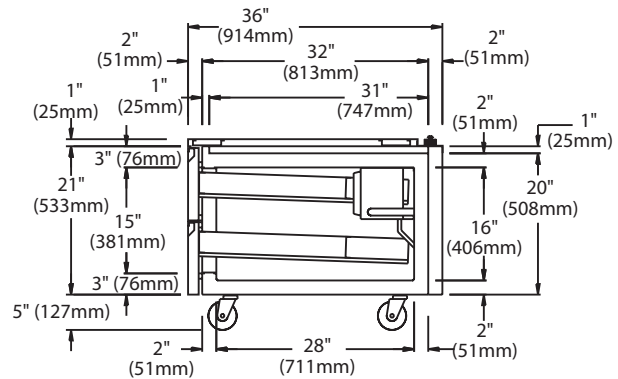
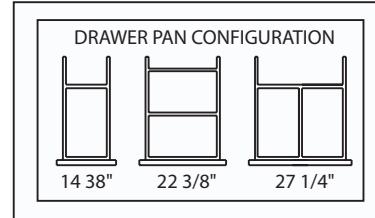

Low Height Refrigerations: 21" (533mm) Body Height											
Remote Units Model	Length: Ins(mm)	Depth: Ins(mm)	Height: Ins(mm)	Drawer Size Openings			Hotel Pans	Utilities			
				14-3/8"	22-3/8"	27-1/4"		Volts	Amps	Phase	BTU'S
BRRR-1-02-36US	36(914)	34(864)	27(686)			2	3	115	0.73	1ph	1000
BRRR-2-04-48US	48(1219)	34(864)	27(686)	2	2		5	115	1.5	1ph	1300
BRRR-2-04-54US	54(1372)	34(864)	27(686)	2		2	6	115	1.5	1ph	1300
BRRR-2-04-60US	60(1524)	34(864)	27(686)		2	2	8	115	1.5	1ph	1300
BRRR-2-04-66US	66(1676)	34(864)	27(686)			4	8	115	1.5	1ph	1300
BRRR-2-04-72US	72(1829)	34(864)	27(686)			4	8	115	1.5	1ph	1300
BRRR-3-06-72US	72(1829)	34(864)	27(686)	4		2	8	115	1.5	1ph	1300
BRRR-3-06-84US	84(2134)	34(864)	27(686)		6		12	115	1.5	1ph	1300
BRRR-3-06-90US	90(2286)	34(864)	27(686)		2	4	12	115	1.5	1ph	1300
BRRR-3-06-96US	96(2438)	34(864)	27(686)			6	12	115	1.5	1ph	1300
BRRR-3-06-102US	102(2591)	34(864)	27(686)			6	12	115	1.5	1ph	1300
BRRR-4-06-108US	108(2743)	34(864)	27(686)			6	12	115	1.5	1ph	1300
BRRR-4-08-114US	114(2896)	34(864)	27(686)		6	2	16	115	3	1ph	2600
BRRR-4-08-120US	120(3048)	34(864)	27(686)		4	4	16	115	3	1ph	2600

Low Height Freezers: 21" (533mm) Body Height											
Remote Units Model	Length: Ins(mm)	Depth: Ins(mm)	Height: Ins(mm)	Drawer Size Openings			Hotel Pans	Utilities			
				14-3/8"	22-3/8"	27-1/4"		Volts	Amps	Phase	BTU'S
BFRA-1-02-36US	36(914)	34(864)	27(686)			2	3	115	0.73	1ph	1000
BFRA-1-04-48US	48(1219)	34(864)	27(686)	2	2		5	115	0.73	1ph	1300
BFRA-2-04-54US	54(1372)	34(864)	27(686)	2		2	6	115	1.5	1ph	1300
BFRA-2-04-60US	60(1524)	34(864)	27(686)		2	2	8	115	1.5	1ph	1300
BFRA-2-04-66US	66(1676)	34(864)	27(686)			4	8	115	1.5	1ph	1300
BFRA-2-04-72US	72(1829)	34(864)	27(686)			4	8	115	1.5	1ph	1300
BFRA-3-06-72US	72(1829)	34(864)	27(686)	4		2	8	115	1.5	1ph	1300

Form# BRRR (09/04/08)