



Regal Series Step Up Hot Plate

Item: _____
 Quantity: _____
 Project: _____
 Approval: _____
 Date: _____

Regal Series Step Up Hot Plate

Models:

- RHPR-24 RHPR-36 RHPR-48



Model RHPR-36

Standard Features:

- Stainless steel front, landing ledge and sides
- 24" (610mm) - 48" (1219mm) widths with four to eight open burners
- Heavy duty removable drip pan
- Standing pilot for instant lighting
- Bowl style grate configuration
- 20,000 BTU/hr per burner - natural gas
- 17,500 BTU/hr per burner - propane gas
- Individual burner control
- 4" (102mm) legs with adjustable feet
- 3/4" rear gas connection
- 3/4" gas regulator
- One year parts and labor warranty

Optional Features:

- Stainless steel stand with intermediate shelf
- Swivel casters on stand

Specification:

Shall be U.S. Range Regal Step Up Hot Plate. Model _____ with a total BTU/hr rating of _____ when used with natural/propane gas. Finish is to be stainless steel front and sides.



| Model | Description (W xD) | Total BTU Natural Gas | Total BTU Propane Gas |
|---------|---|-----------------------|-----------------------|
| RHPR-24 | 4 Open Burners 24"(605mm) x 27-1/4"(794mm) | 80,000 | 70,000 |
| RHPR-36 | 6 Open Burners 36"(914mm) x 27-1/4"(794mm) | 120,000 | 105,000 |
| RHPR-48 | 8 Open Burners 48"(1219mm) x 27-1/4"(794mm) | 160,000 | 140,000 |

Garland Commercial Industries, LLC
 185 East South Street
 Freeland, PA 18224
 Phone: (570) 636-1000
 Fax: (570) 636-3903

Garland Commercial Ranges Ltd
 1177 Kamato Road,
 Mississauga, Ontario
 L4W 1X4 CANADA
 Phone: 905-624-0260
 Fax: 905-624-5669

Enodis UK LTD
 Swallowfield Way,
 Hayes, Middlesex
 UB3 1DQ ENGLAND
 Telephone: 081-561-0433
 Fax: 081-848-0041



| Specifications | | | | Total BTU | | |
|----------------|----------------------|-------------|---------|----------------|-------------|-------------|
| Model # | Dimensions: In. (mm) | | | No. of Burners | Natural Gas | Propane Gas |
| | Width | Depth | Height | | | |
| RHPR-24 | 24(605) | 27-1/4(794) | 13(330) | 4 | 80,000 | 70,000 |
| RHPR-36 | 36(914) | 27-1/4(794) | 13(330) | 6 | 120,000 | 105,000 |
| RHPR-48 | 48(1219) | 27-1/4(794) | 13(330) | 8 | 160,000 | 140,000 |

Many local codes exist and it is the responsibility of the owner and installer to comply with those codes.

Garland/U.S. Range products are not approved or authorized for home or residential use, but are intended for commercial applications only. Garland / U.S. Range will not provide service, warranty, maintenance or support of any kind other than in commercial applications.

| Shipping Information | | |
|----------------------|--------------|-------|
| Model# | Weight Lb/Kg | Cu Ft |
| RHPR-24 | 138/61 | 8.0 |
| RHPR-36 | 191/87 | 25.0 |
| RHPR-48) | 247/112 | 33.0 |

| Operating Pressure All Models | | | |
|-------------------------------|------|---------|------|
| Natural Gas | | Propane | |
| "WC | Mbar | "WC | Mbar |
| 5 | 12.5 | 10 | 25 |

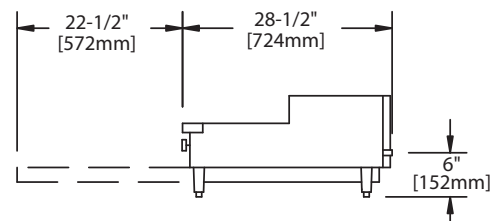
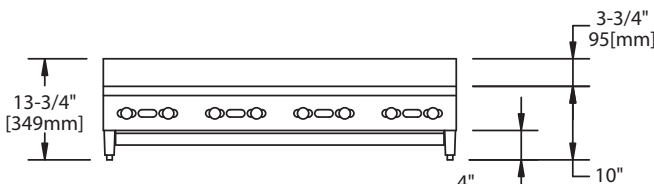
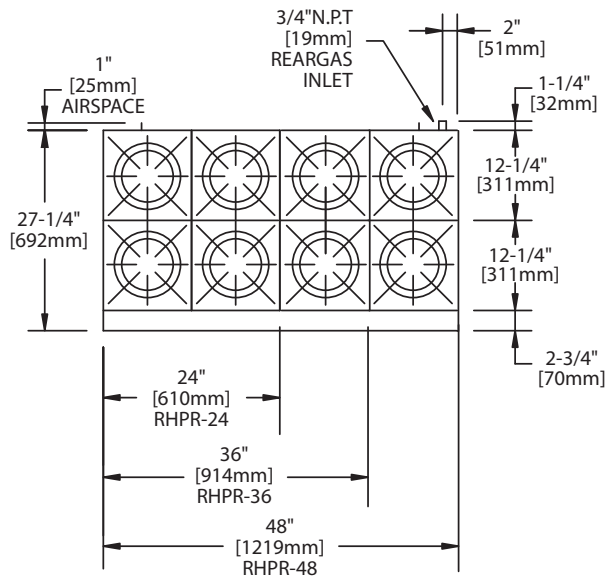

Form# RHPR (06/07)

Garland Commercial Industries, LLC
185 East South Street
Freeland, PA 18224
Phone: (570) 636-1000
Fax: (570) 636-3903

Garland Commercial Ranges Ltd
1177 Kamato Road,
Mississauga, Ontario
L4W 1X4 CANADA
Phone: 905-624-0260
Fax: 905-624-5669

Enodis UK LTD
Swallowfield Way,
Hayes, Middlesex
UB3 1DQ ENGLAND
Telephone: 081-561-0433
Fax: 081-848-0041