



# GX Series Gas Hot Plates

Item: \_\_\_\_\_

Quantity: \_\_\_\_\_

Project: \_\_\_\_\_

Approval: \_\_\_\_\_

Date: \_\_\_\_\_

GX Series Gas Hot Plates

Models:

- GXHP11       GXHP22       GXHP42       GXHP84  
 GXHP21       GXHP33       GXHP63



Model GXHP42

Standard Features:

- Heavy-duty, removable drip pan
- 20,000 BTU/hr. per burner - natural gas
- 17,500 BTU/hr. per burner - propane gas
- Individual burner controls
- Standing pilot for instant lighting
- 3/4" gas regulator
- 4" (102mm) legs with adjustable feet
- Exterior finish - stainless steel front sides, landing ledge and valve cover

Optional Features:

- Stainless steel stand with intermediate shelf  
 Casters on stand - swivel type

Specification:

Shall be GX series Hot Plate, Model \_\_\_\_\_ with total BTU/hr rating of \_\_\_\_\_ when used with natural/propane gas. Finish is to be stainless steel front and sides.



Model No.	Description	TOTAL BTU	SHIPPING INFORMATION	
		Natural/ Propane	Lbs/Kg	Cu. Ft.
GXHP11	1 Open Burner - 12"(305mm) W x 16"(406mm) D	20,000/17,500	50/23	4
GXHP21	2 Open Burners - 12"(305mm) W x 28"(711mm) D	40,000/35,000	73/33	4
GXHP22	2 Open Burners - 24"(610mm) W x 16"(406mm) D	40,000/35,000	81/37	8
GXHP33	3 Open Burners - 36"(914mm) W x 16"(406mm) D	60,000/52,500	123/56	25
GXHP42	4 Open Burners - 24"(610mm) W x 28"(711mm) D	80,000/70,000	135/61	8
GXHP63	6 Open Burners - 36"(914mm) W x 28"(711mm) D	120,000/105,000	191/87	25
GXHP84	8 Open Burners - 48"(1'219mm) W x 28"(711mm) D	160,000/140,000	247/112	33

Garland Commercial Industries, LLC  
185 East South Street  
Freeland, PA 18224  
Phone: (570) 636-1000  
Fax: (570) 636-3903

Garland Commercial Ranges Ltd  
1177 Kamato Road,  
Mississauga, Ontario  
L4W 1X4 CANADA  
Phone: 905-624-0260  
Fax: 905-624-5669

Enodis UK LTD  
Swallowfield Way,  
Hayes, Middlesex  
UB3 1DQ ENGLAND  
Telephone: 081-561-0433  
Fax: 081-848-0041



Model #	Dimensions			No. of Burners	Total Nat. Gas BTU	Total Pro. Gas BTU
	Width	Depth	Height			
GXHP11	12"(305mm)	16"(406mm)	10"(254mm)	1	20,000	17,500
GXHP21	12"(305mm)	28"(711mm)	10"(254mm)	2	40,000	35,000
GXHP22	24"(610mm)	16"(406mm)	10"(254mm)	2	40,000	35,000
GXHP33	36"(914mm)	16"(406mm)	10"(254mm)	3	60,000	52,500
GXHP42	24"(610mm)	28"(711mm)	10"(254mm)	4	80,000	70,000
GXHP63	36"(914mm)	28"(711mm)	10"(254mm)	6	120,000	105,000
GXHP84	48"(1219mm)	28"(711mm)	10"(254mm)	8	160,000	140,000

Operating Pressure All Models	
Natural Gas	Propane
5" WC (12.5 Mbar)	10" WC (25 Mbar)
Gas Manifold 3/4" NPT	

Garland/U.S. Range products are not approved or authorized for home or residential use, but are intended for commercial applications only. Garland / U.S. Range will not provide service, warranty, maintenance or support of any kind other than in commercial applications.

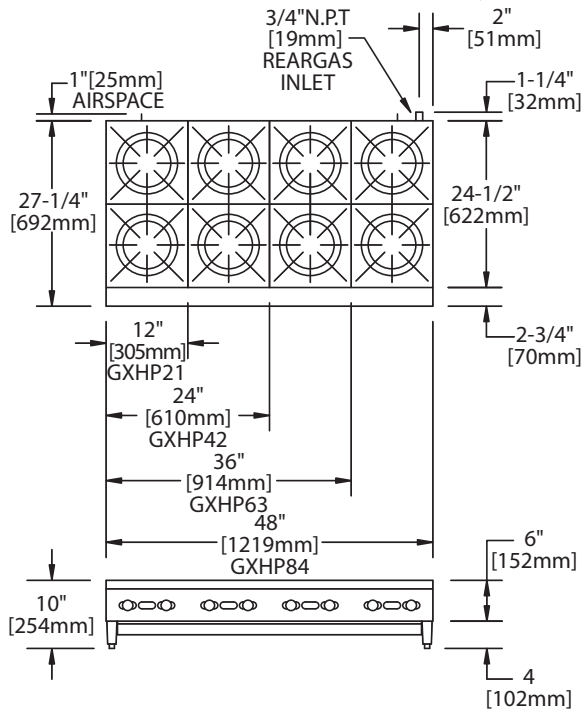
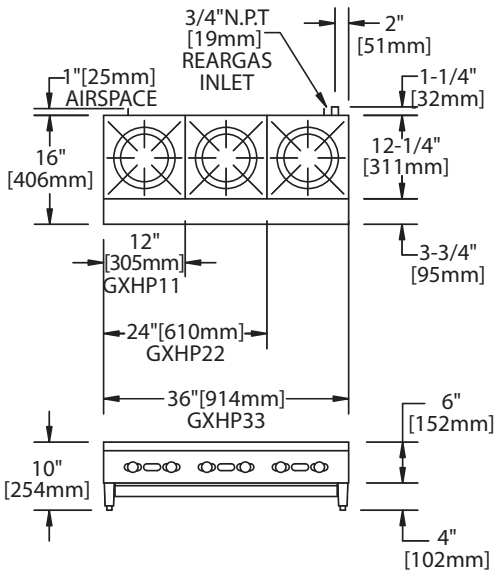
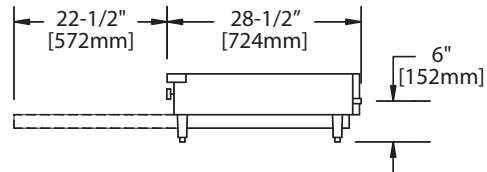
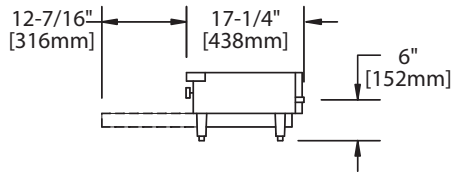

Many local codes exist and it is the responsibility of the owner and installer to comply with those codes.

Form# GXHP (06/07)