



Electric Counter Top Single Deck Oven

Item: _____
 Quantity: _____
 Project: _____
 Approval: _____
 Date: _____

Electric Counter Top Single Deck Oven

Models:

- AP1 APA

AIR PAC



Model # AP1

Standard Features:

- Stainless steel front, sides, top, and legs
- Heavy -duty pull-down front door
- Removable bottom jet plate
- Adjustable steel wire oven rack (two positions)
- Electronic controls with precision timers
- Single speed fan with 1/4 HP motor (0.5 kW)
- 4.7 kW element package
- 4-1/2" (114mm) stainless steel adjustable legs
- One year limited parts and labor warranty on ovens

Optional Features:

- Stacking oven only (w/o top, w/o legs), -Specify APA. Stacking oven cannot be operated alone. Stacking kit included.
- Extra stainless wire rack (s)
- Perforated stainless steel pizza deck, adjustable (two positions)

Specification:

All-purpose counter top deck oven with a unique energy delivery system of controlled hot air flow for fast, consistent operation. Offers minimum pre-heat time, consistent selected temperatures high quality production, and menu versatility. Single units can be stacked up to three high. Available on 208 or 240 volt, Single or 3 Phase (60 Hz only). Please specify.



Garland Commercial Industries, LLC
 185 East South Street
 Freeland, PA 18224
 Phone: (570) 636-1000
 Fax: (570) 636-3903

Garland Commercial Ranges Ltd
 1177 Kamato Road,
 Mississauga, Ontario
 L4W 1X4 CANADA
 Phone: 905-624-0260
 Fax: 905-624-5669

Enodis UK LTD
 Swallowfield Way,
 Hayes, Middlesex
 UB3 1DQ ENGLAND
 Telephone: 081-561-0433
 Fax: 081-848-0041

Enodis®

Oven Interior Dimensions*			Exterior Dimensions			Cu Ft	Shipping Weight Lbs./Kg	
Width	Height	Depth	Width	Height	Depth		Crated	Uncrated
19-1/4" (489mm)	4-3/4" (121mm)	17-3/4" (451mm)	36-1/2" (927mm)	16-1/2" (419mm)	34-1/4" (870mm)	21	230/104	140/64

*With rack or pizza deck in place Two fixed rack positions: 1-1/8" (28mm) and 1-5/8"(41mm)

Clearances				
Combustible Wall Clearance			Entry Clearance	
Left	Right	Rear	Crated	Uncrated
0" (0mm)	6" (152mm)	6" (152mm)	32" (813mm)	13" (330mm)

Electrical Requirements	Nominal Amperes Per Line								
	Single Phase		208V/3 Phase			240V/3 Phase			
Total kW	208V	240V	X	Y	Z	X	Y	Z	
5.2	25	21.7	17	10	17	15	9	15	

208 VAC = 197 VAC to 219 VAC 240 VAC = 220 VAC to 252 VAC
(60 Hz only)

AIR PAC

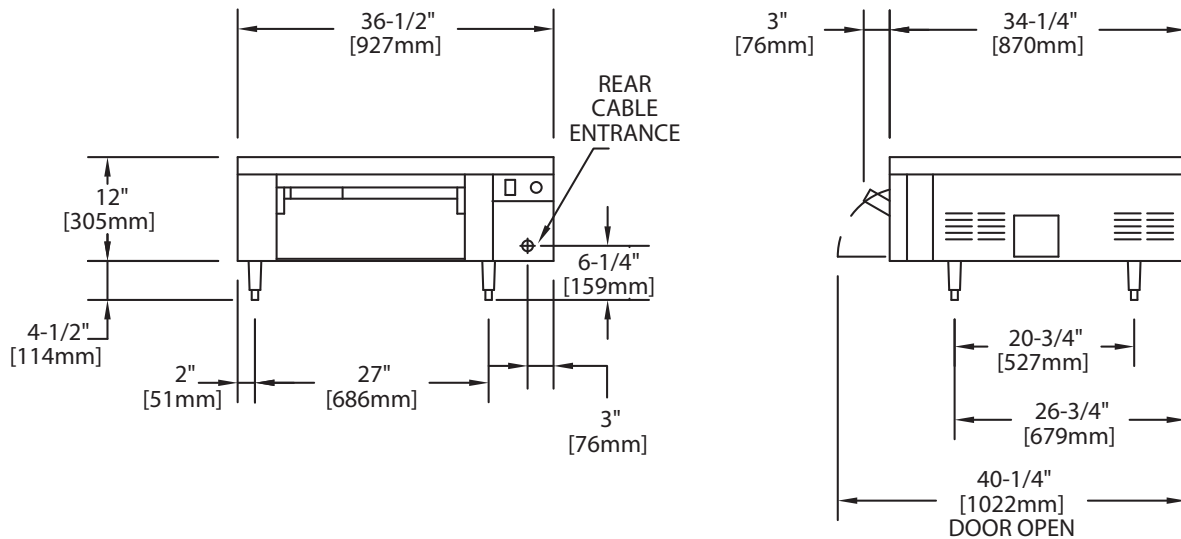

Garland products are not approved or authorized for home or residential use, but are intended for commercial applications only. Garland will not provide service, warranty, maintenance or support of any kind other than in commercial applications.

Form# AP1 (04/28/08)